

## Jonathan furlong's line weights in section for debt.

### For this, I have a slightly different work around than most people.

See attached file, and although its not exactly what I want with a few small improvements it would work for me and most people I think at least in the interim.

Let me know what you think.

What I do is- make several sections

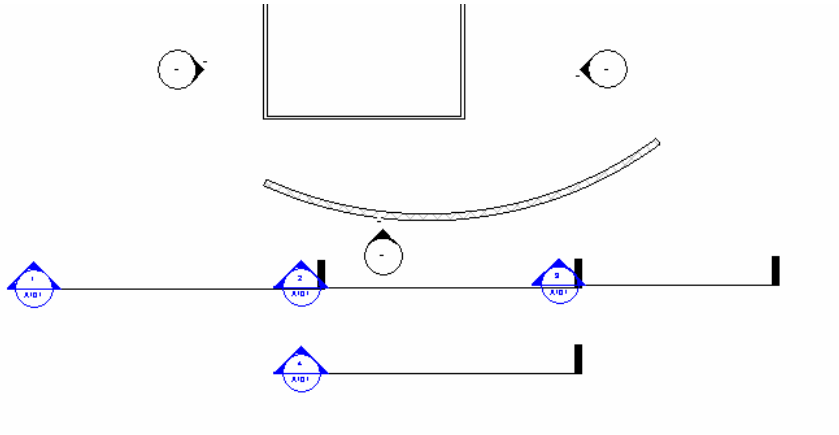

and place them end to end,

then in each section I set up line style overrides for walls, windows and other necessary objects.

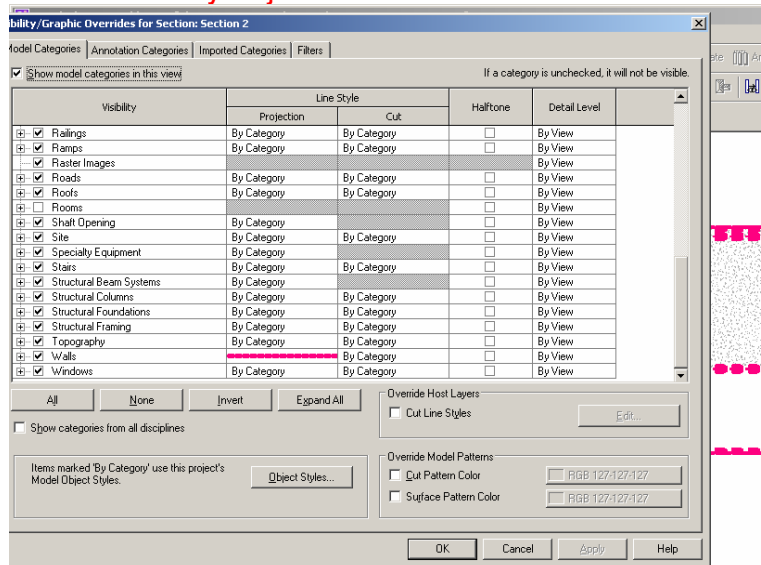

Then I turn off the levels under V V in all but one section.

Then I bring the sections onto a sheet.

Then I move them together.

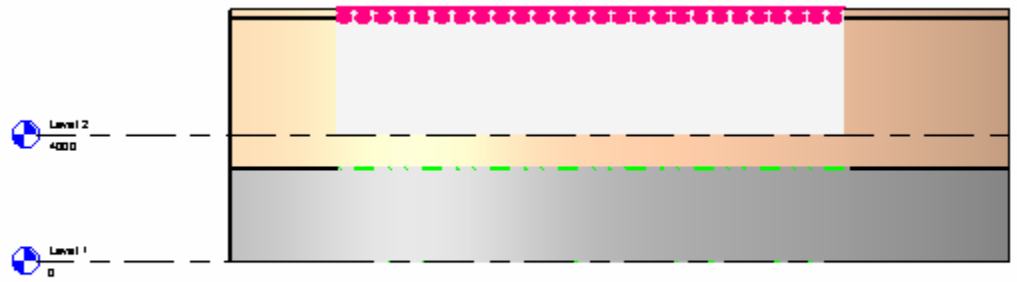

1 Section 1  
1 : 100

Problem's with this is.  
Section lines in plan wont snap together so sometimes the joins are not perfect see below

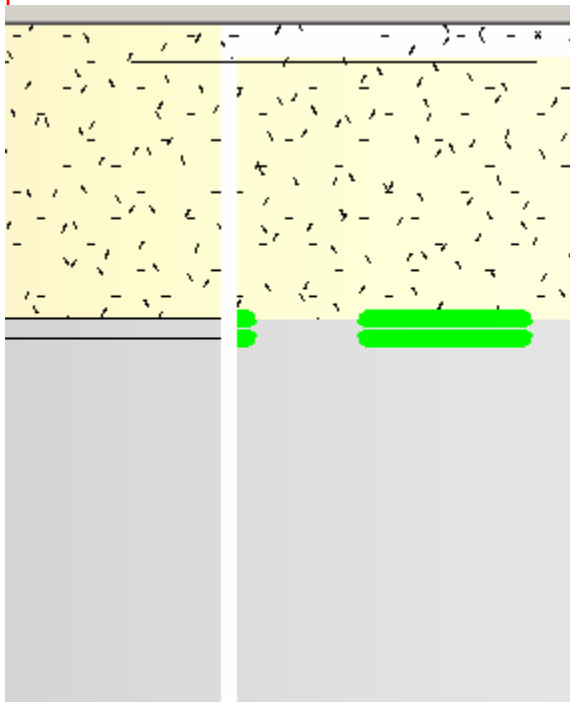

In a sheet view I can't snap or align between different views so I can't get the joins perfect. Also see above.

If Autodesk could fix the 2 small things I think most people would find this acceptable.?